

1. Turn on your tablet and click [Setting]

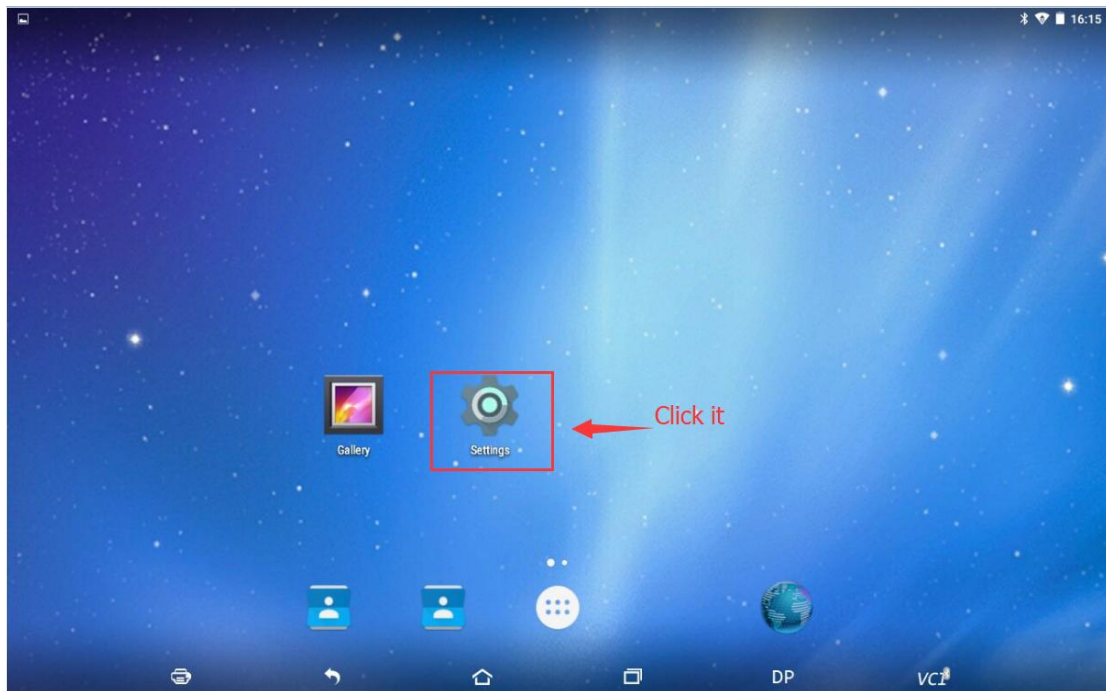

2. Click [Backup & reset]

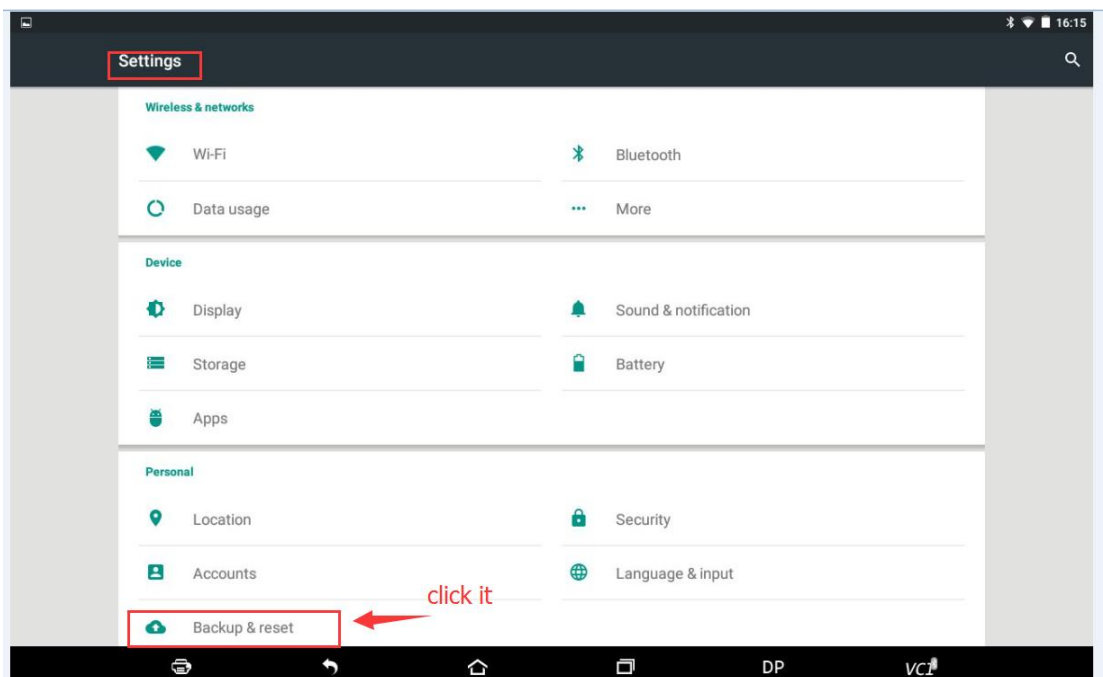

3. Click [Factory data reset]

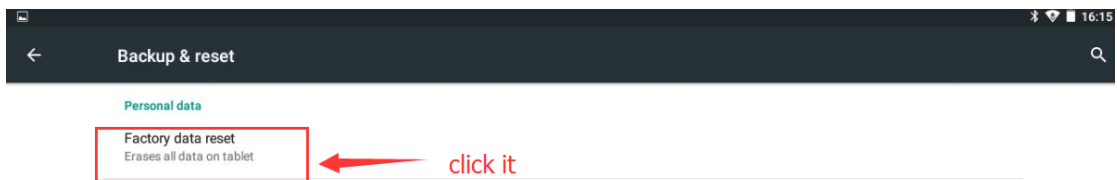

4. Power on VCI. Connect VCI and tablet by using USB.



5. Click [Setting]

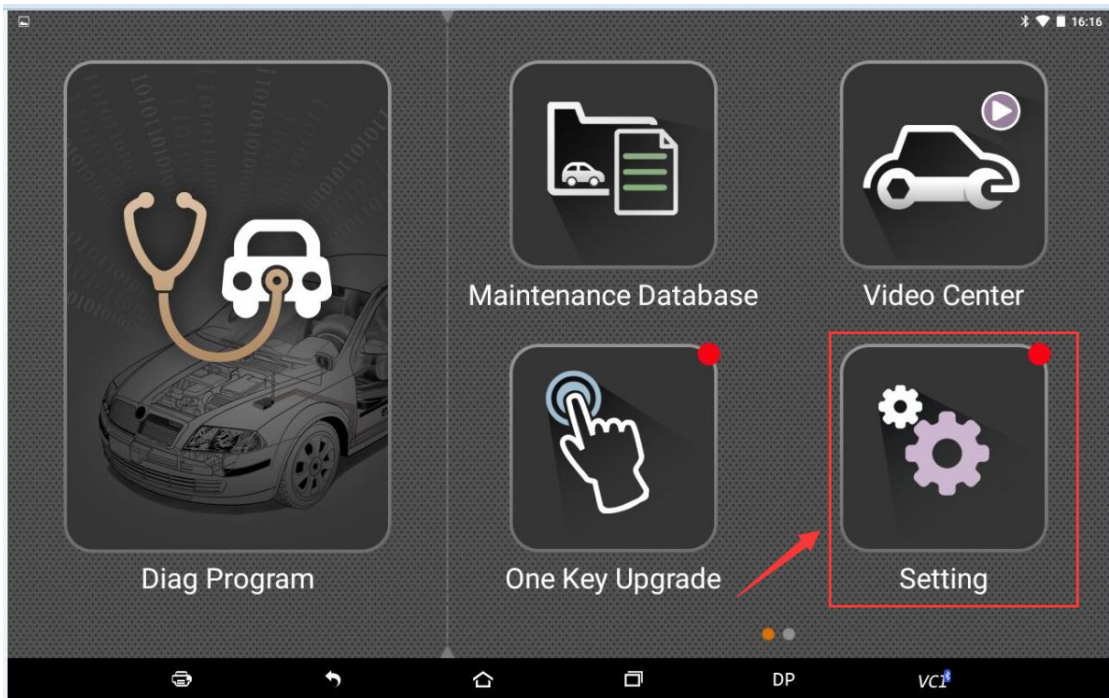

6. Click [Self test] and [Communication test]

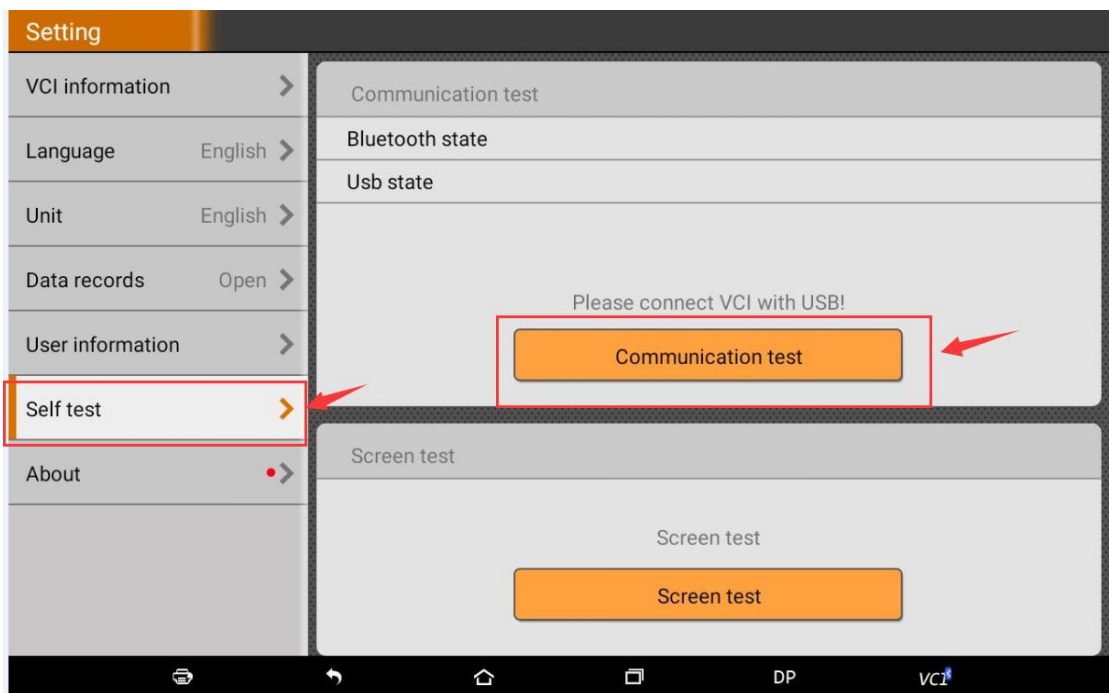

7. Please remove USB after the Bluetooth state and USB state show ok.

8. Click [one key upgrade]

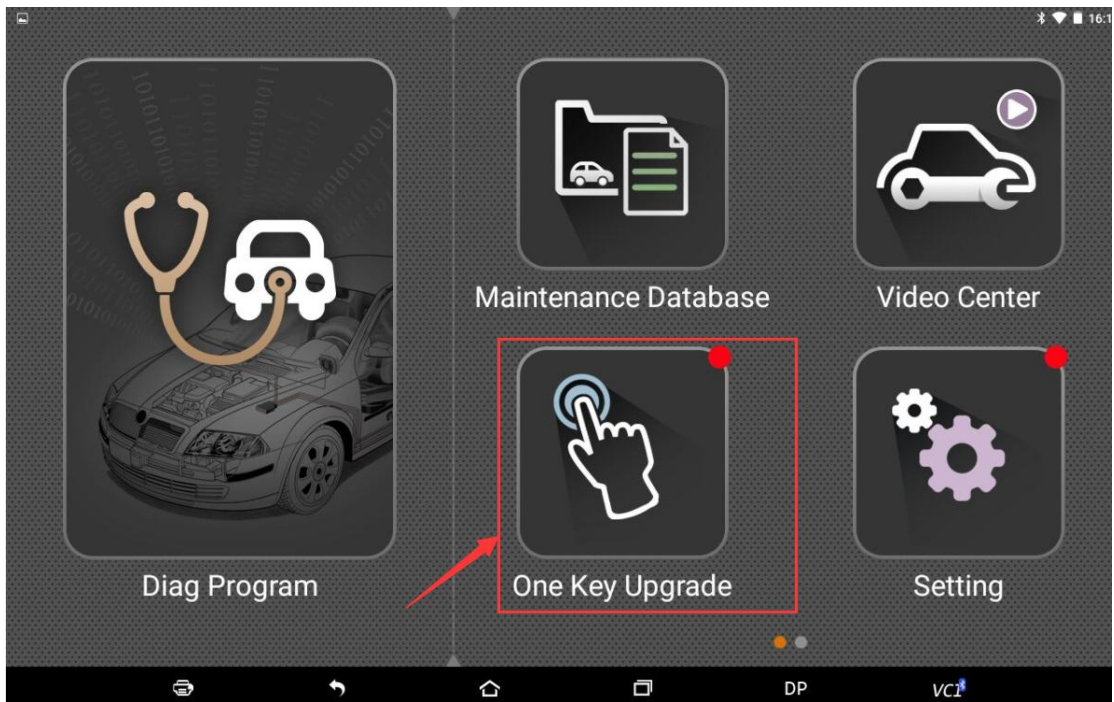

END